

Electronic Tape Dispenser M-1000/ M-2000 MS-1100/ MS-2200

Instruction Manual

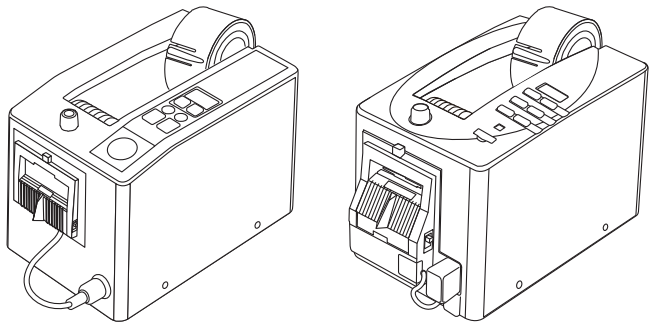

Thank you very much for purchasing our "Electronic Tape Dispenser". Please read this instruction manual before using or when it's necessary.

Contents

1 Notice	1.1 Product comparison _____	1
	1.2 ⚠ Warning _____	2
	1.3 ⚠ Caution _____	2
2 Description of parts and function	2.1 For M-1000 / M-2000 _____	3
	2.2 For MS-1100 / MS-2200 _____	4
3 Operation	3.1 Setting up _____	5
	3.2 Loading tape _____	5
	3.3 Sets tape length _____	6
	3.4 Resets saved length _____	6
	3.5 Using automatic feed _____	7
	3.6 Using manual feed _____	7
	3.7 Safety shutter (Safety device) 1100 2200 _____	7
	3.8 How to release “Err” “---” error 1100 2200 _____	7
	3.9 Changing tape _____	8
	3.10 How to remove jammed tape _____	8
	3.11 Length memory function 1100 2200 _____	9
	3.12 Changing saved preset lengths _____	10
4 Maintenance	4.1 Replacing separating roller unit _____	11
	4.2 Maintenance of cutter blades _____	11
	4.3 Replacing cutter and cutter liner _____	12
5 Specifications		13

1 Notice

This instruction manual is for our tape dispensers, model No. M-1000, M-2000, MS-1100 and MS-2200.

Refer to following comparison for differences of each models:

1.1 Product comparison

Model No.	M-1000	M-2000	MS-1100	MS-2200
Automatic feed and cut	●	●	●	●
Length memory	—	●	—	●
Safety shutter	—	—	●	●

Refer to page 9 for details of length memory. **2000 2200**

Refer to page 7 for details of safety shutter. **1100 2200**

1.2 ⚠ Warning

Do NOT insert your fingers into cutting head.

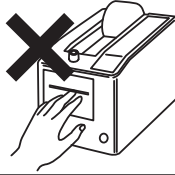

1.3 ⚠ Caution

Do NOT put flammable onto the unit.

Do NOT use the unit under unsteady place.

Do NOT use the unit in humid or dusty place.

Do NOT disassemble or modified the tape dispenser.

Make sure to pull the plug out when the unit is moved or replacing parts.

Do NOT insert bars or plates in to the tape outlet. This will damage blades.

Do NOT drop the unit or subject it to heavy shocks.

Do NOT use volatile liquids (thinner, benzene, etc.) to clean the unit. Wipe with dry cloths only.

Do NOT use damaged cable. This may cause a fire or electric failure.

Do NOT use the unit near volatile liquid.

Do NOT clean the unit by any flammable materials.

Do not operate the unit near flammable materials (including flammable gas spray), Failure to do this may cause fire.

Do NOT disassemble, repair or modify the AC adaptor.
It may cause fire, electric shock or malfunction.

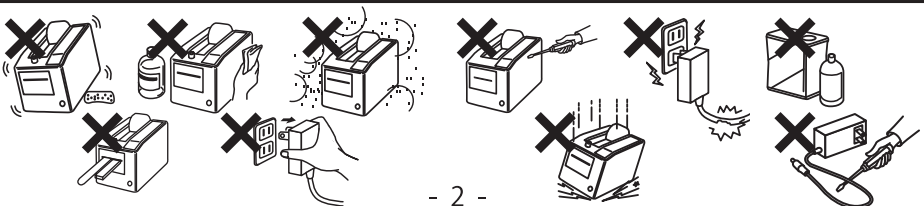

2 Description of parts and function

2.1 For M-1000 / M-2000

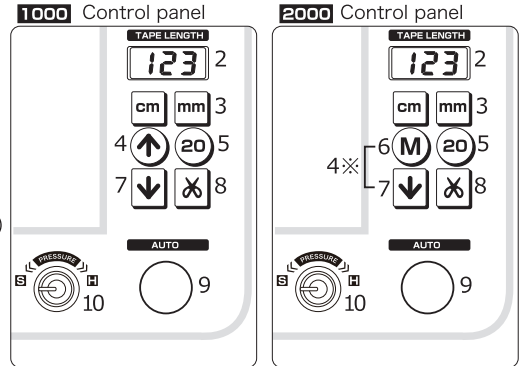
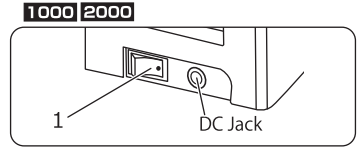
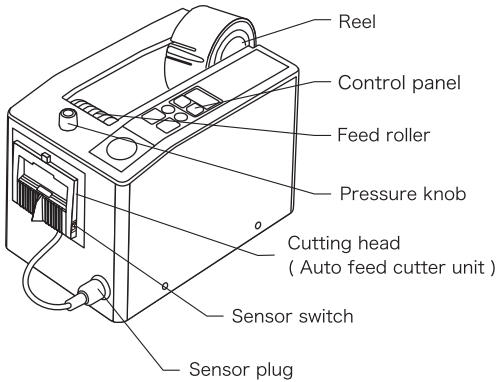

1 Power switch	Press to turn power ON or OFF.
2 Tape length display	Shows tape length and error.
3 Length adjustment key	The last digit indicates " mm " (0 - 9mm) and the first two digits " cm " (20 - 990mm).
4 Reverse key	<p>1000 Feed roller reverses by pressing ↑. Use this key for changing tape.</p> <p>2000 Feed roller reverses by pressing M+↓. Use this key for changing tape.</p>
5 20(reset)key	Resets length display reset and back to min set length of 20mm.
6 Memory key	2000 Press and hold it till the LED display flashes for saving memory. Saved lengths can be selected by short pressing of this key.
7 Feed key	Tape dispenses as long as ↓ is pressed.
8 Cut key	Press ✂ to cut tape.
9 Auto Key	Press AUTO to feed tape to the preset length and cuts automatically.
10 Pressure knob	Adjust press (top) roller to change pressure on tape.

2.2 For MS-1100 / MS-2200

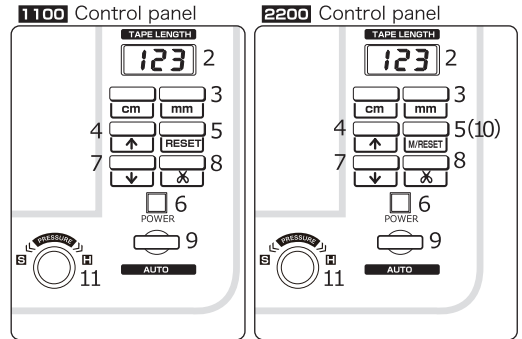
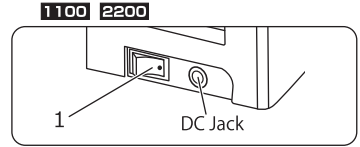
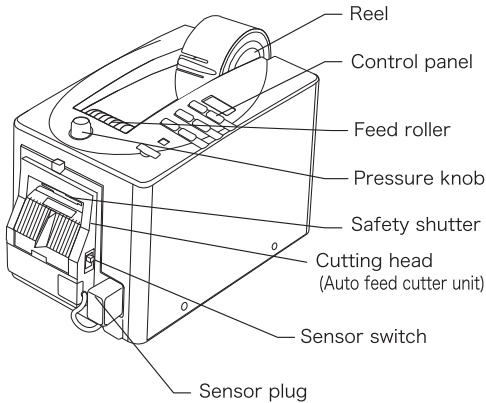

1 Power switch	Press to turn power ON or OFF
2 Tape length display	Shows tape length and error.
Length adjustment key	The last digit indicates “ mm ” (0-9mm) and the first two digits “ cm ” (30 – 990mm). mm + cm : Back to min set length of 30mm
4 Reverse key	Feed roller reverses by pressing ↑ . Use this key for changing tape.
5 Reset key (M/RESET for 2200)	RESET Release error by pressing this key for 2 times.
6 Power LED	<input type="checkbox"/> Lamp goes on when the power is turned ON.
7 Feed key	Tape dispenses as long as ↓ is pressed.
8 Cut key	Press ✂ to cut tape.
9 Auto Key	Press AUTO to feed tape to the preset length and cuts automatically.
10 Memory key	2200 M/RESET Press and hold it till the LED display flashes for saving memory. Saved lengths can be checked by short pressing of this key.
11 Pressure knob	Adjust press (top) roller to change pressure on tape.

3 Operation

3.1 Setting up

 Attention	Make sure power and sensor switches are OFF for safety purpose
---	--

- ① Plug sensor plug into the unit.
- ② Plug power cord in.
- ③ Turn the power switch ON.

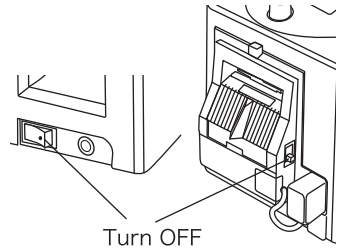

1000 2000

Min set length of 20 will be shown on the LED display.

LED display



1100 2200

Min set length of 30 will be shown on the LED display.

LED display



3.2 Loading tape

- ① Pull the reel out from the unit.
Load tape on the reel and place to the unit.
- ② Make sure to position the tape on the center of the reel.
- ③ Fold corner of the tape to form a trapezoid shape (Fig.). Stick the tape onto metal feed roller.
- ④ Press “ ↓ ” until tape feeds through cutting head.

(Fig.) Fold tape back

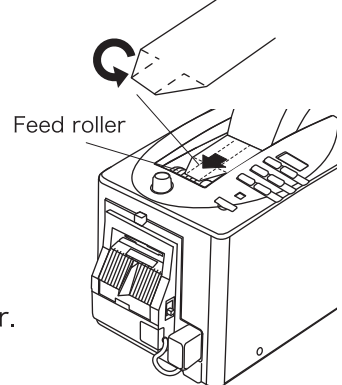

⑤ Adjust “Pressure knob” in accordance with tape.

- If tape curls up or slips, increase pressure.(clockwise)
- If tape creases, decrease pressure.(counter clockwise)



⑥ Advance 3cm – 4cm of the tape out from the cutting head.

⑦ Press “ ✂ ” to cut the tape.

⑧ Remove tape

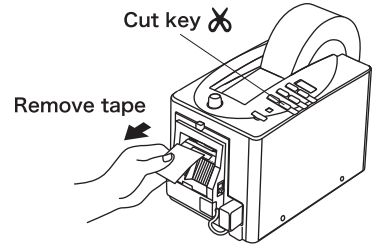

3.3 Sets tape length

Make sure sensor switch is OFF.

Press “ **mm** ” and “ **cm** ” for setting length.

① Press “ **mm** ” to set length of 0-9mm(Last digit)

② Press “ **cm** ” to set length of **1000 2000** 20 -990mm / **1100 2200** 30 -990mm.(First two digits)

* Keep pressing button for quick change.

* Last setting length is saved even main power is turned OFF.

LED display

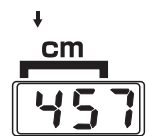
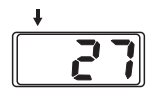

3.4 Resets saved length

1000 2000 Press “ **20** ” to reset and back to min set length of 20mm.



1100 2200 Press “ **mm + cm** ” to reset and back to min set length of 30mm.

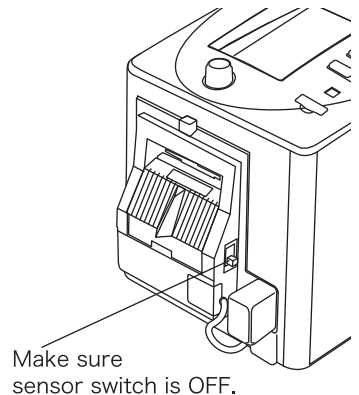

3.5 Using automatic feed

- ① Turn sensor switch ON.
- ② Tape will be fed set length and cut.
- ③ Remove a piece of tape from machine.
- ④ Another piece will be fed and cut.

Remove a piece of tape

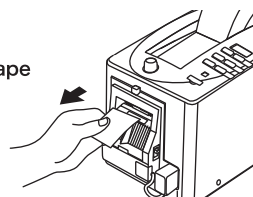

Automatically set length is fed and cut

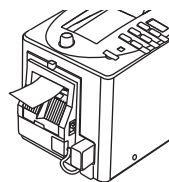

3.6 Using manual feed

- ① Turn sensor switch OFF.
- ② Press “ **AUTO** ” .
- ③ Whenever “ **AUTO** ” is pressed, set length is fed and cut.

Press “Auto key”

Turn sensor switch OFF.

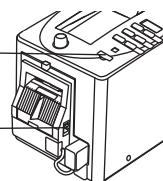

3.7 Safety shutter (Safety device) **1100 2200**

Safety shutter system prevents activation of cutter when foreign objects are present.

- ※ When safety device is activated, show error (**Err**) on the LED display.
- ※ “ - - - ” error will be shown, if any keys are pressed while display shows “ **Err** ” error.
- ※ No safety shutter for **1000** and **2000** .

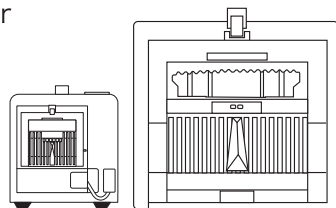

safety shutter activated

3.8 How to release “ **Err** ” “ - - - ” error **1100 2200**

- ① Remove cutting head from the unit.
 - ② Remove jammed tape.
 - ③ Move shutter and cutter by tool and back them to the right position (Fig.).
 - ④ Press “ **RESET** ” (1st press)
 - ⑤ LED display shows length.
 - ⑥ Press “ **RESET** ” again. (2nd press)
 - ⑦ Error will be released.
- ※ Ask distributor or **ECT Inc.** in case error can't be released.

(Fig.)

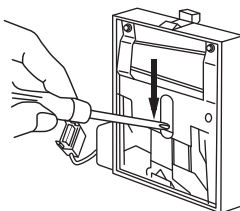

3.9 Changing tape

① Turn sensor switch OFF.

② Press “ ↑ ” to reverse tape.

2000 “ M ” + “ ↓ ” .

The feed roller will rewind the tape away from cutter area.

③ Remove whole reel out from the unit and replace tape.

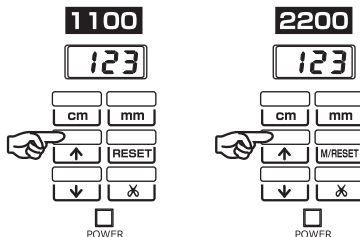
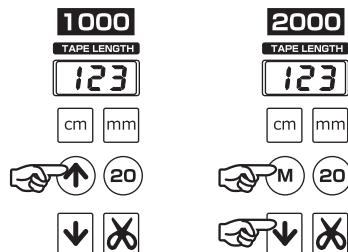

3.10 How to remove jammed tape

① Press “ ↑ ” to reverse tape.

“ M ” + “ ↓ ” for reverse. **2000**

※ Hold the tape and wind it backward slightly as per (Fig.) .

② Remove tape from metal roller.

③ Cut wrinkled part of tape.

● In case of heavy tape jam.

① Remove cutting head from the unit.

② Cut wrinkled part of tape.

③ Remove jammed tape by tweezers.

※ In case tape is wrapped around any rollers, those need to be cut by scissors.

Make sure roller wouldn't be damaged.

● If tape jammed in the cutting head.

① Remove cutting head from the unit.

② Check the gap of the blade on the back.

③ Remove jammed tape by tweezers.

※ When its heavy jam, cutter spring need to be removed.

See details for page 12.

(Fig.) Wind the tape backward slightly

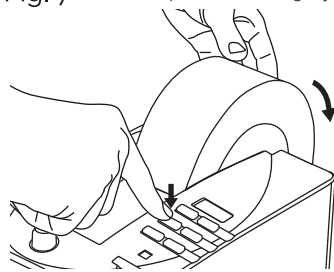



Make sure sensor switch is OFF for safety purpose.

3.11 Length memory function **2000 2200**

Set preset lengths and select a mode.

3 different lengths can be saved, and 2 different modes are selectable.

Preset mode (on " 0 ")

On " 0 ", the machine will feed and cut the first set length until the " M " is pressed, then it will feed the second length until the " M " is pressed, and so on.

LED display



Loop mode (on " 5 ")

On " 5 ", the machine will feed and cut the recorded length in series.

LED display

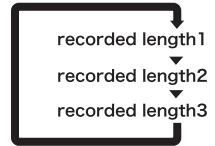

STEP.1 Save lengths

2000 Press and hold " M " (" " for **2200**) until the LED display START flashing.
※LED display flash = Setting mode

Press and hold



recorded length1

e.g. length 50mm

1st preset length (Memory 1)

Press " mm " , " cm " and set the length to register memory 1.

2000 Press " M " (for **2200**) for completing 1st length registration.



recorded length2

e.g. length 100mm

2nd preset length (Memory 2)

Press " mm " , " cm " and set the length to register memory 2.

2000 Press " M " (for **2200**) for completing 2nd length registration.

※If no need to register 2nd preset length, leave " 999 " and

2000 press " M " (for **2200**).



3rd preset length (Memory 3)

recorded length3 e.g. length 300mm

Press " mm ", " cm " and set the length to register memory 3.

※ If no need to register 3rd preset length, leave " 999 " .



2000 Press " M " (for **2200**) for completing all registration.

Then "0" will be shown on the LED display.



STEP.2 Select the mode

On " 0 " : Preset mode

2000 Press and hold " M " (" for **2200**)

Press and hold

until the LED display STOP flashing.

1st preset length will be shown.



On " 5 " : Loop mode

Press " mm " .



And " 0 " will be turned to " 5 " .

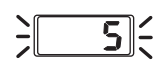

2000 Press and hold " M " (" for **2200**)

Press and hold

until the LED display STOP flashing.

1st preset length will be shown.

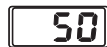

All setting for " Preset mode " has been completed.

All setting for " Loop mode " has been completed.

3.12 Changing saved preset lengths

● Change all

2000 Press " 20 " for deletes all setting.



2200 1. Turn the main power OFF.

2. Turn the main power ON while keep pressing " for deletes all setting.



● Change 1 or 2 preset lengths **2000** **2200**



① **2000** Press and hold " M " (" for **2200**) until the LED display START flashing.

② **2000** Press " M " (" for **2200**) and find length, you'd like to change.

③ Press " mm " " cm " keys and change length.

④ **2000** Press and hold " M " (" for **2200**) until the LED display STOP flashing. 1st preset length will be shown and complete changing preset length.

4 Maintenance

 Caution	For safety reason, make sure to pull power cord out from power outlet for any maintenance.
 Caution	Do NOT touch cutter blade!

4.1 Replacing separating roller unit

Rubber rings on "Separating roller unit" are consumable part. Regular replacement is required for keeping the best feeding condition.

- ① Remove cutting head.
- ② Unscrew ① and ②.
- ③ Pinch centre of separating roller unit and pull it out.
- ④ Replace with new unit.

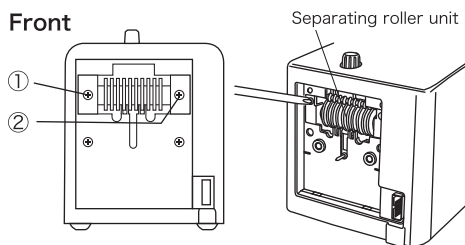
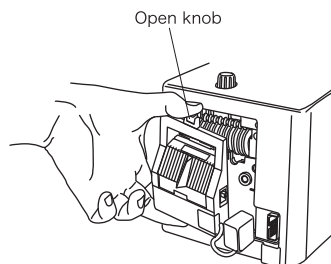

4.2 Maintenance of cutter blades

 Caution	Remove the auto-feed cutter unit from the machine when using alcohol. Failure to do this may cause fire.
---	--

Although special coating is applied on our cutter blade, glue will be built up eventually.

In order to maintain the best cutting condition, remove accumulated glue regularly. Use alcohol for removal.

Then use enclosed "silicone oil" for less glue building up.

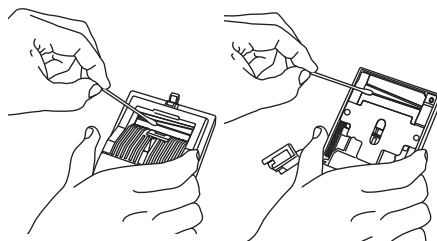



Caution

Pay extra attention when blades are replaced !!

4.3 Replacing cutter and cutter liner

Cutter and cutter liner are consuming part.

Regular replacement of cutting head, (or cutter blades, liners individually) is required for keep the best cutting condition.

- ① Remove cutting head.
- ② Turn 2 screws and remove "cutter spring".

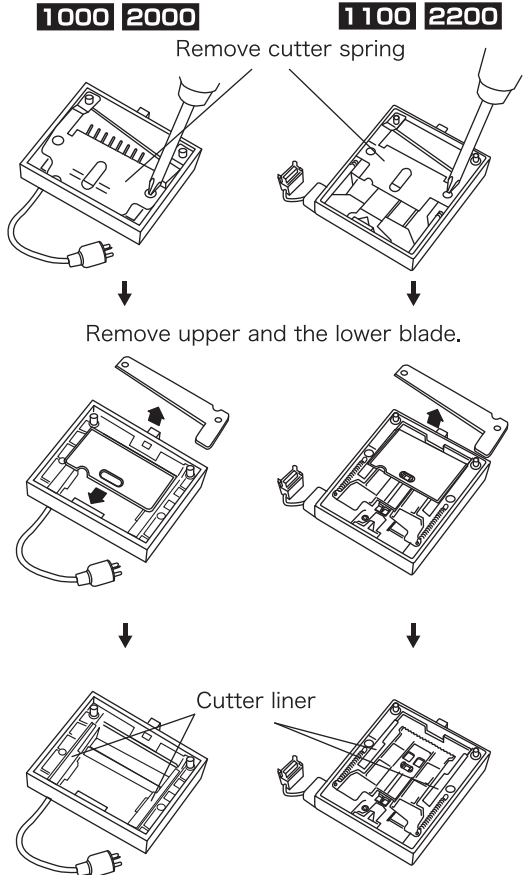

- ③ Remove cutter blades.
- ④ Make sure the direction and replace "cutter liners", if those are worn out.
- ⑤ Make sure the direction and replace cutter blades.

⑥ Put cutter spring back.

⑦ Fasten cutter spring by 2 screws.

Make sure the right direction for blades.

Cutter

Cutter

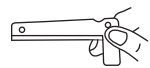
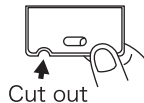

5 Specifications

Model No.	M-1000	M-2000	MS-1100	MS-2200
Display	3 digits LED			
Applicable Tape width	7 - 50mm ※ "Magnetic Tape Guide" as an option is suggested for 7 - 30mm width tape.			
Cut length	20 - 999mm		30 - 999mm	
Core (Reel) diameter	3-in-1 reel (25mm, 35mm, 76mm) (1", 1.4", 3")			
Max outside Dia. of tape	φ 170mm (Larger reel stand is available as an option part)			
Usable tapes	Cellophane, Kraft, Cloth, PP, Double-sided, Filament, Creped, etc. ※ Following kind of tapes are possibly affect for smooth feeding or cutting: Curls, Strong adhesive, Black color, High transparency, Too thin, Slippery, Generates much static			
Drive	DC motor for tape feeding and cut			
Power consumption	18W			
Power (MainUnit):	DC18V 1A (use dedicated AC adaptor)			
AC adaptor	Input: AC100 ~ 240V 50/60Hz 1.5A Output: DC 18V 2.5A Cord length: 1.8m			
Ambient illumination	Fluorescent : 3,000 lx or less LED lighting : 10,000 lx or less Sun light : 10,000 lx or less ※Not for outdoor use.			
Ambient Temp and Humidity	5°C - 40°C, 80% RH or less			
Size (W×L×H)	137×245×156mm	137×245×156mm	137×249×156mm	137×249×156mm
Weight	About 2.2kg (include AC Adaptor and reel)		About 2.3kg (include AC Adaptor and reel)	
Cabinet material	ABS plastic			
Country of origin	MADE IN JAPAN			

※ Accuracy of cut is about ±2mm (depends on tape).

※ Specifications are subject to change without notice.

✉ info@ectinc.co.jp

🏠 www.ectinc.co.jp

电子胶带机

M-1000/ M-2000

MS-1100/ MS-2200

使用说明书

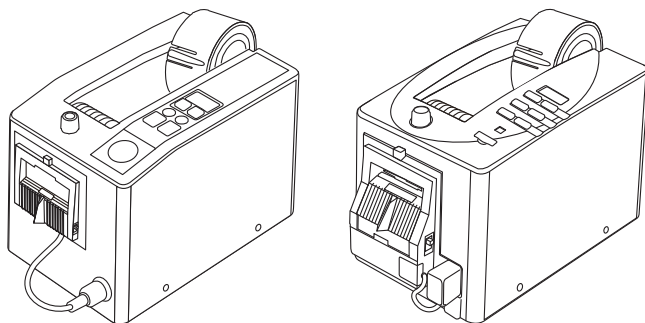

感谢您购买本公司的“电子胶带机”。
请在使用前或有需要时阅读本
使用说明书。

目录

1 注意	1.1	产品比较	15
	1.2	⚠ 警告	16
	1.3	⚠ 注意	16
2 零件和功能描述	2.1	M-1000 / M-2000	17
	2.2	MS-1100 / MS-2200	18
3 操作	3.1	安装	19
	3.2	安装胶带	19
	3.3	设置胶带长度	20
	3.4	重新设置胶带长度	20
	3.5	使用自动送带功能	21
	3.6	使用手动送带功能	21
	3.7	安全快门 (安全装置) 1100 2200	21
	3.8	如何解除“Err”“---”错误 1100 2200	21
	3.9	更换胶带	22
	3.10	如何解除卡带	22
	3.11	长度记忆功能 1100 2200	23
	3.12	更改保存的预置长度	24
4 维护	4.1	更换剥离滚轮组件	25
	4.2	维护切割刀片	25
	4.3	更换刀具及刀具垫片	26
5 规格			27

1 注意

本使用说明书适用于本公司的电子胶带机 M-1000、M-2000、MS-1100 及 MS-2200 型号。请参阅以下不同型号的比较表：

1.1 产品比较

型号	M-1000	M-2000	MS-1100	MS-2200
自动送带及切割	●	●	●	●
记忆长度	—	●	—	●
安全快门	—	—	●	●

记忆长度资料，请参阅第 23 页。**2000 2200**

安全快门资料，请参阅第 21 页。**1100 2200**

1.2 ⚠ 警告

请勿将手指放进切割头。



1.3 ⚠ 注意

请勿将易燃物品放进胶带机。

请勿在不平稳的地方使用胶带机。

请勿在潮湿或布满灰尘的地方使用胶带机。

请勿拆卸或改动胶带机。

确保移动胶带机或更换零件时一定要拔掉插头。

请勿在胶带机插入板状或条状物。否则会损坏刀片。

请勿将胶带机掉在地上或令胶带机受到重击。

请勿使用挥发性液体（稀释剂、苯等）清洁胶带机。只可使用干布清洁胶带机。

请勿使用损坏了的电源线。这样会导致火灾或电气故障。

请勿靠近挥发性液体处使用胶带机。

不可用具有易燃性的物质清洗胶带机
不可在具有易燃性物质附近使用胶带机（包括易燃性气体喷雾）。否则，会导致火灾。

请勿拆卸、修理或改动电源适配器。否则，会导致火灾、短路或故障。

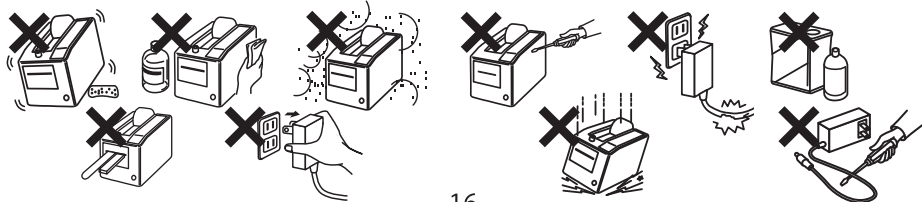

2 零件和功能描述

2.1 M-1000 / M-2000

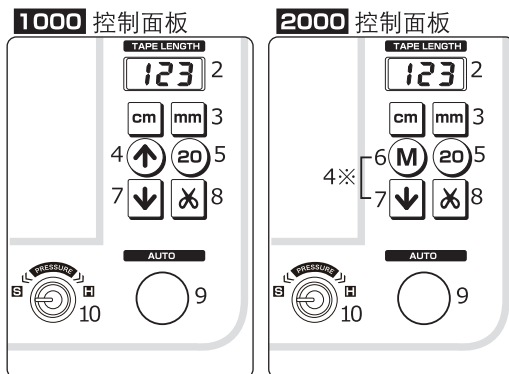
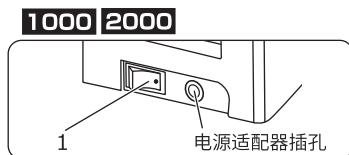
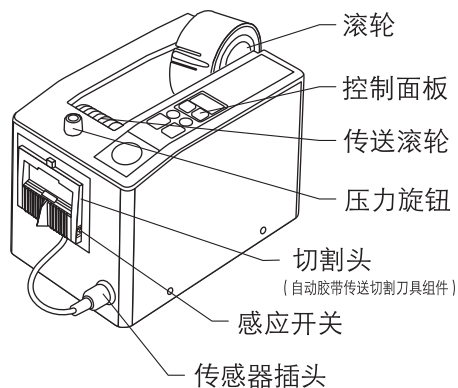

1 电源开关	按电源开关开动或关闭电源。
2 胶带长度显示	显示胶带长度或错误。
3 长度调整键	最后的数位显示 “mm” (0-9 毫米) 前两位数显示 “cm” (20-990 厘米)
4 反转键	1000 按 ↑ 以反转传送滚轮。更换胶带请使用这个键。 ----- 2000 按 M + ↓ 以反转传送滚轮。更换胶带请使用这个键。
5 20(复位)键	重新设置长度显示，并返回最短设置长度的 20 毫米处。
6 记忆键	2000 长按记忆键直至发光二极管显示屏闪烁，以存入资料。 短按本键以选择已储存长度。
7 传送键	按 ↓ 以传送胶带。按的时间越长传送的胶带越长。
8 切割键	按 ✂ 以切割胶带。
9 自动键	按 AUTO 以传送已设定长度胶带并作自动切割。
10 压力旋钮	调整压力（上）轮以变更对胶带的压力。

2.2 MS-1100 / MS-2200

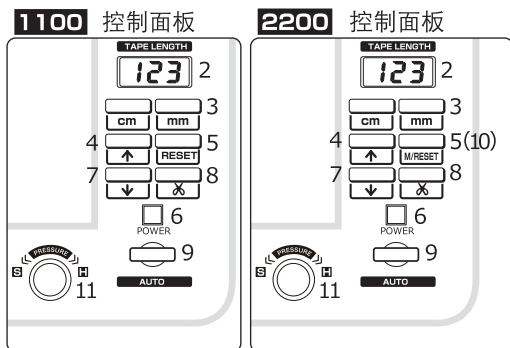
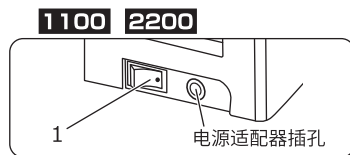
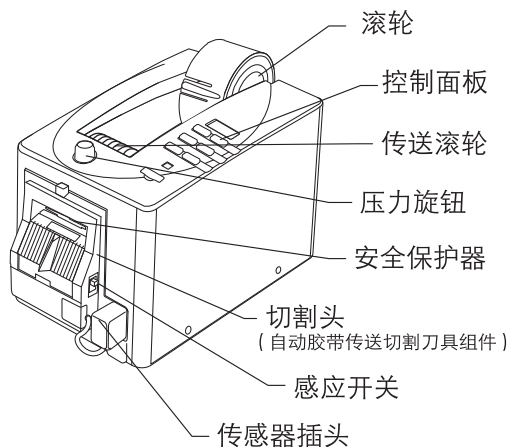

1 电源开关	按电源开关开动或关闭电源。
2 胶带长度显示	显示胶带长度或错误。
3 长度调整键	最后的数位显示 “ mm ” (0-9 毫米) 前两数位显示 “ cm ” (20-990 厘米) mm + cm = 胶带设定长度最短为 30 毫米。
4 反转键	按 ↑ 以反转传送滚轮。更换胶带请使用这个键。
5 复位键 (2200 型号, 按 M/RESET 键)	RESET 复位 按此键两次以消除错误
6 LED 电源	电源开启时 <input type="checkbox"/> 灯泡会亮着
7 传送键	按 ↓ 以传送胶带。按的时间越长传送的胶带越长。
8 切割键	按 ✂ 以切割胶带。
9 自动键	按 AUTO 以拉出已设定长度胶带并作自动切割。
10 记忆键	2200 M/RESET 长按记忆键直至发光二极管显示屏闪烁，以存入资料。 短按本键以选择已储存长度。
11 压力旋钮	调整压力 (上) 轮以变更对胶带的压力。

3 操作

3.1 安装



出于安全考虑，请确保电源及感应开关已被关闭。

① 传感器插头插入胶带机。

② 插入电源线。

③ 把电源开启。

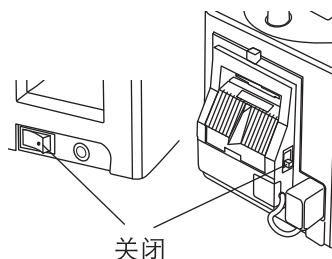

1000 2000

LED 显示屏显示的胶带的长度为最短的 20 毫米。

LED 显示屏



1100 2200

LED 显示屏显示的胶带长度为最短的 30 毫米。

LED 显示屏



3.2 安装胶带

① 将滚轮从胶带机取出。

把胶带装到滚轮上并放入胶带机。

② 确保胶带被放置在滚轮中央。

③ 将胶带一角折成梯形（如图）。将胶带贴在金属传送滚轮上。

④ 按“传送键”直至胶带被拉出切割头。

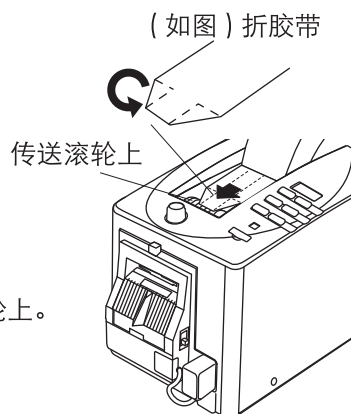

⑤ 根据胶带调整“压力旋钮”

- 如果胶带蜷曲或脱落，请增加压力（顺时针）
- 如果胶带出现压痕，请减少压力（逆时针）



⑥ 从切割头再拉出 3-4 厘米胶带。

⑦ 按“切割键”切割胶带。

⑧ 取出胶带。



3.3 设置胶带长度

确保感应开关已被关闭。

按“mm”及“cm”键以设定长度。

① 按“mm 键”以设定 0-9 毫米长度（最后数位）。

② 按“cm 键”以设定

（**1000 2000** 的）20-990 毫米长度 /

（**1100 2200**）30-990 毫米长度（前两数位）。

※ 持续按键以作出快速改变。

※ 虽然主电源关闭，但最后长度设定已被储存。

LED 显示屏



↓ 毫米

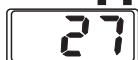

↓



↓ 厘米

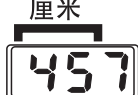

3.4 重新设置胶带长度

1000 2000 按

“20 键”以重新设置长度为最短的 20 毫米。

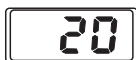

1100 2200 按

“mm 键 + cm 键”以重新设长度为最短的 30 毫米。

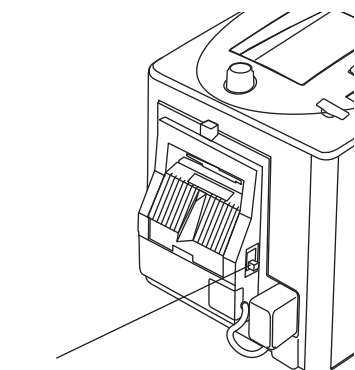

确保感应开关已被关闭。

3.5 使用自动送带功能

- ① 开启感应开关。
- ② 胶带以预设长度传送并被切割。
- ③ 从胶带机取出切好的胶带。
- ④ 另一片胶带再度以预设长度传送并被切割。

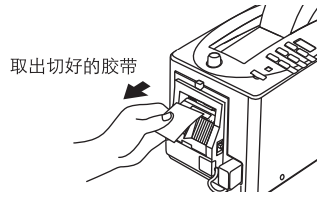

3.6 使用手动送带功能

- ① 关闭感应开关。
- ② 按“**AUTO**键”。
- ③“**AUTO**键”被按时，
胶带以预设长度传送并被切割。

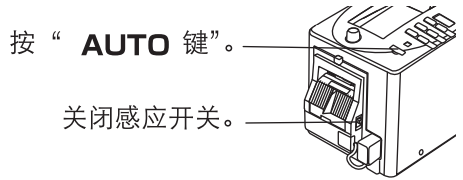

3.7 安全快门 (安全装置) **1100 2200**

外来物体存在时，安全快门系统防止刀片开动。

※ 当安全装置启动，LED 显示屏上显示错误 (**Err**)。

※ 如果在任何按键被按时显示错误

“**Err**”字样，则“**---**”错误将会被显示。

※ **1000** 及 **2000** 没有安全快门。

安全快门被启动

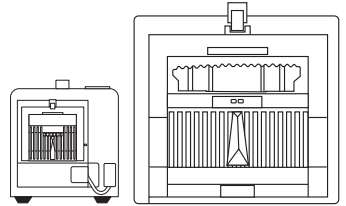

3.8 如何解除“**Err**”“**---**”错误 **1100 2200**

- ① 从胶带机取出切割头。
- ② 取出卡着的胶带。
- ③ 利用工具移动快门及刀片到正确位置。(如图)
- ④ 按“重新设置”按钮。(第一次按)
- ⑤ LED 显示屏上显示长度。
- ⑥ 再按一次“重新设置”按钮。(第二次按)
- ⑦ 错误将被删除。

(如图)

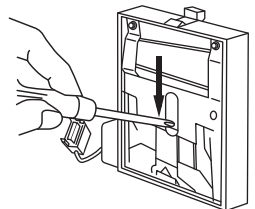

※ 如果错误不能被删除，请咨询经销商或 **ECT Inc.**。

3.9 更换胶带

① 关闭感应开关。

② 按“↑键”以反转胶带。

2000 按“M键”+“↓键”。

传送滚轮会将胶带反转离开切割位置。

③ 将整个滚轮从胶带上取出并更换胶带。

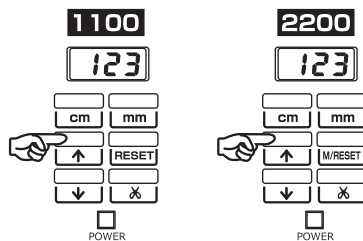
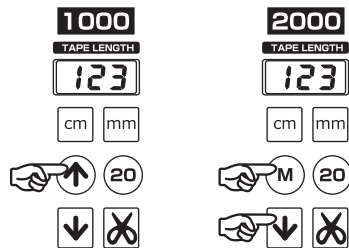

3.10 如何解除卡带

① 按“↑键”以反转胶带。按“M键”+“↓键”反转胶带 **2000**。

※拿着胶带并如（图）稍微反转。

② 从金属滚轮取出胶带。

③ 把胶带皱起部分剪去。

（如图）拿着胶带并稍微反转

●如果卡带情况严重

① 从胶带机取出切割头。

② 切断胶带的皱起部份。

③ 利用镊子取出卡着的胶带。

※如果有胶带包裹任何滚轮，请用剪刀剪去胶带。

确保滚轮不会被损坏。

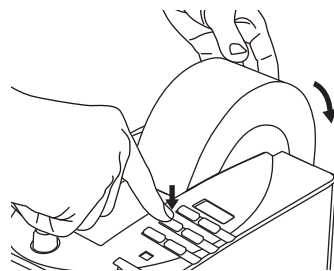

●如果胶带被卡在切割头

① 从胶带机取出切割头

② 检查后面刀片的间隙。

③ 利用镊子取出卡着的胶带。

※当出现严重卡带的情况，刀具弹簧应被取出。

详情请参看第 26 页。



出于安全考虑，请确保感应开关已被关闭。

3.1.1 长度记忆功能 **2000 2200**

设置长度和选择模式

您可以设置 3 个不同长度，及选择两个不同模式。

LED 显示屏



设置模式 (显示 “0”)

当显示“0”时，胶带机将会传送并剪切第一节设置长度的胶带，直至“M 键”被按下为止；然后，胶带机将会传送并剪切第二节设置长度的胶带，直至“M 键”被按下为止，以此类推。

LED 显示屏



循环模式 (显示 “5”)

当显示“5”时，胶带机将依次传送并剪切设置长度的胶带。

第一步 存储长度

2000 长按“M 键” (**2200**，按“ 键”)，直至 LED 显示屏开始闪烁。

※LED 显示屏闪烁 = 设置模式

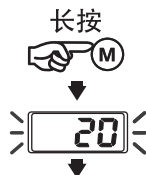

第一设置长度 (记忆 1)

按“mm”、“cm”并设置长度以记录记忆 1。

2000 按“M 键” (**2200**，按“ 键”)以完成登记第一长度。

记录长度 1 例如，长度 50mm

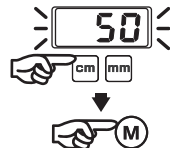

第二设置长度 (记忆 2)

按“mm”、“cm”并设置长度以记录记忆 2。

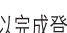
2000 按“M 键” (**2200**，按“ 键”)以完成登记第二长度。

※如果不需要登记第二长度，屏幕留下“999”字样及

2000 按“M 键” (**2200**，按“ 键”)。

记录长度 2 例如，长度 100mm

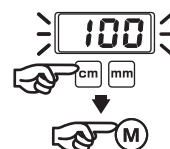

第三设置长度 (记忆 3)

记录长度 3 例如, 长度 300mm

按 “mm”、“cm” 并设置长度以记录记忆 3。

※如果不需要登记第三长度, 屏幕留下 “999” 字样



2000 按 “M 键” (**2200** , 按 “ 键”) 以完成所有登记。

LED 显示屏将会显示 “0” 字。



第二步选择模式

显示 “0”: 设置模式

2000 长按 “M” 键
(**2200** , 长按 “ 键”) 直至 LED 显示屏停止闪烁。



第一设置长度将会被显示。



显示 “5”: 循环模式

按 “mm 键”, 而 “0” 字将会变为 “5” 字。



2000 长按 “M” 键
(**2200** , 长按 “ 键”) 直至 LED 显示屏停止闪烁。



第一设置长度将会被显示。

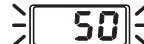

“预设模式” 所有设置经 已完成。

“循环模式” 所有设置经 已完成。

3.12 更改保存的预设长度

●更改所有

2000 按 “20 键” 消除所有设置。



2200 1. 关闭主电源。

2. 开启主电源并长按 “ 键” 以消除所有设置。



长按

开启

●更改 1 或 2 预设长度 **2000** **2200**

① **2000** 长按 “M” 键 (**2200** , 长按 “ 键”) 直至 LED 显示屏开始闪烁。



② **2000** 长按 “M” 键 (**2200** , 长按 “ 键”) 并找寻您希望改变的长度。

③ 按 “毫米”、“厘米” 键以变更胶带长度。

④ **2000** 长按 “M” 键 (**2200** , 长按 “ 键”) 直至 LED 显示屏停止闪烁。

第一预设长度将会被显示, 并完成更改预设长度。

4 维护

 注意	出于安全考虑，请确保您在进行任何维护前将电源线从电源插座上拔掉。
 注意	请勿触摸切割刀片

4.1 更换剥离滚轮组件

剥离滚轮组件上的橡胶密封圈是耗材。

为保持最佳传送状态，请定期更换橡胶密封圈。

- ① 取下切割头。
- ② 拧开①及②
- ③ 捏住剥离滚轮组件中间位置并将其拉出。
- ④ 更换新剥离滚轮组件。

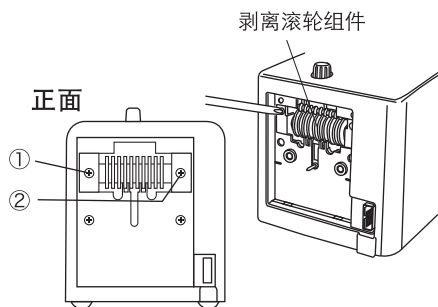
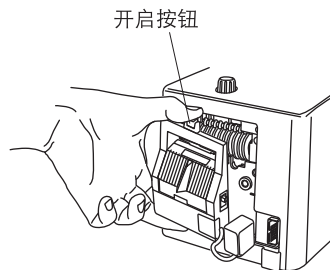

4.2 维护切割刀片

 注意	由于有着火的危险性，在使用酒精类物质清洗刀片时，请将自动切割头单独取下
--	-------------------------------------

虽然本公司的刀片表面被涂上特别涂料，

但胶水仍然会黏在刀片表面。

为了保持最佳切割状态，请定时清除

黏在刀片表面的残胶。请使用酒精清除残胶。

然后，请使用附送的硅油减少残胶集结。

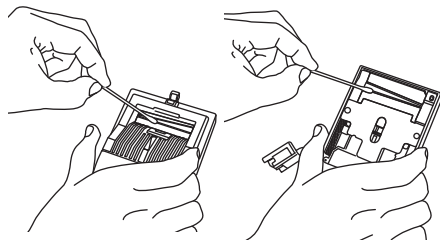



注意

更换刀片时请格外小心。

4.3 更换刀具及刀具垫片

刀具及刀具垫片是耗材。

为保持最佳切割效果，

请定时更换切割头

(或单个的刀片、刀具垫片)。

① 取下切割头。

② 松开两颗螺丝并取下刀具弹簧。

1000 2000

1100 2200

取下刀具弹簧

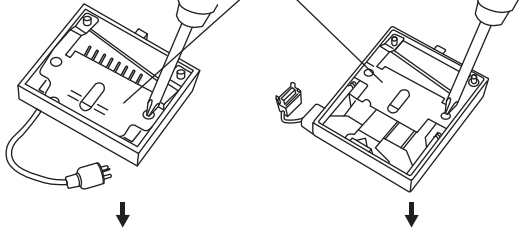

取下上下刀片

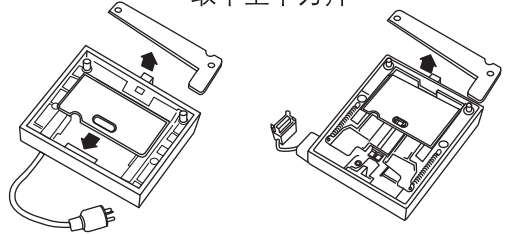

③ 取下刀片。

④ 确保插入方向正确并更换残旧的刀具垫片。

⑤ 确保插入方向正确并更换刀片。

⑥ 装回刀具弹簧。

⑦ 以两颗螺丝固定刀具弹簧。

确保刀片插入方向正确

刀片

刀片

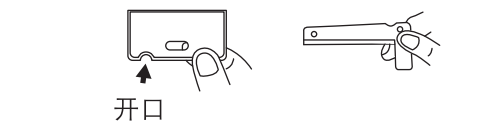

开口

! 注意
在松开螺丝时请按紧刀具弹簧防止
刀具弹簧弹出。

5 规格

型号	M-1000	M-2000	MS-1100	MS-2200
显示	3 位数发光二极管			
适用胶带宽度	7 - 50 毫米 ※7-30 毫米 宽胶带作为选择, 请参阅 “ 磁性胶带指南 ”			
切割长度	20 - 999 毫米		30 - 999 毫米	
(滚轮) 芯直径	3 合 1 滚轮 (25 毫米、35 毫米、76 毫米) (1”、1.4”、3”)			
胶带最大外径	170 毫米 (可用大型滚轮架作为选购零件)			
适用胶带	玻璃纸胶带、牛皮纸胶带、布基胶带、PP 胶带、双面胶带、玻纤胶带、美纹纸胶带 ※ 以下种类胶带可能影响顺利传送或切割 卷曲、粘性超强、黑色、高透明度、太薄、光滑、多静电			
驱动	用于胶带传送及切割的 DC 马达			
功率	18W			
主机电源	DC 18V 1A (使用专用电源适配器)			
电源适配器	输入: AC100 ~240V 50/60Hz 1.5A 输出: DC 18V 2.5A 电源线长度: 1.8m			
可使用照度	荧光灯: 3,000 lx 以下 LED照明: 10,000 lx 以下 阳光: 10,000 lx 以下 ※不可在户外使用本机。			
环境温度和湿度	5°C - 40°C, 80 % RH 或以下			
尺寸(宽 x 长 x 高)	137×245×156 毫米	137×245×156 毫米	137×249×156 毫米	137×249×156 毫米
重量	大约 2.2 公斤 ※含电源适配器及滚轮		大约 2.3 公斤 ※含电源适配器及滚轮	
外壳材质	ABS 树脂			
生产地	日本制造			

※ 切割精度大约 ±2 毫米 (取决于胶带) ※ 规格改变不作另行通知

✉ info@ectinc.co.jp

🏠 www.ectinc.co.jp